

# Customer Care Solutions

## NHM-10 Series Cellular Phones

# 2 - Parts List & Layouts

## Table of Contents

	Page No
Exploded view of Nokia NHM-10, 3600 .....	3
Assembly Parts List .....	4
Parts List Module ----- for NHM-10 .....	5
Component layout diagram Top .....	23
Component layout diagram Bottom .....	24

# Exploded view of Nokia NHM-10, 3600

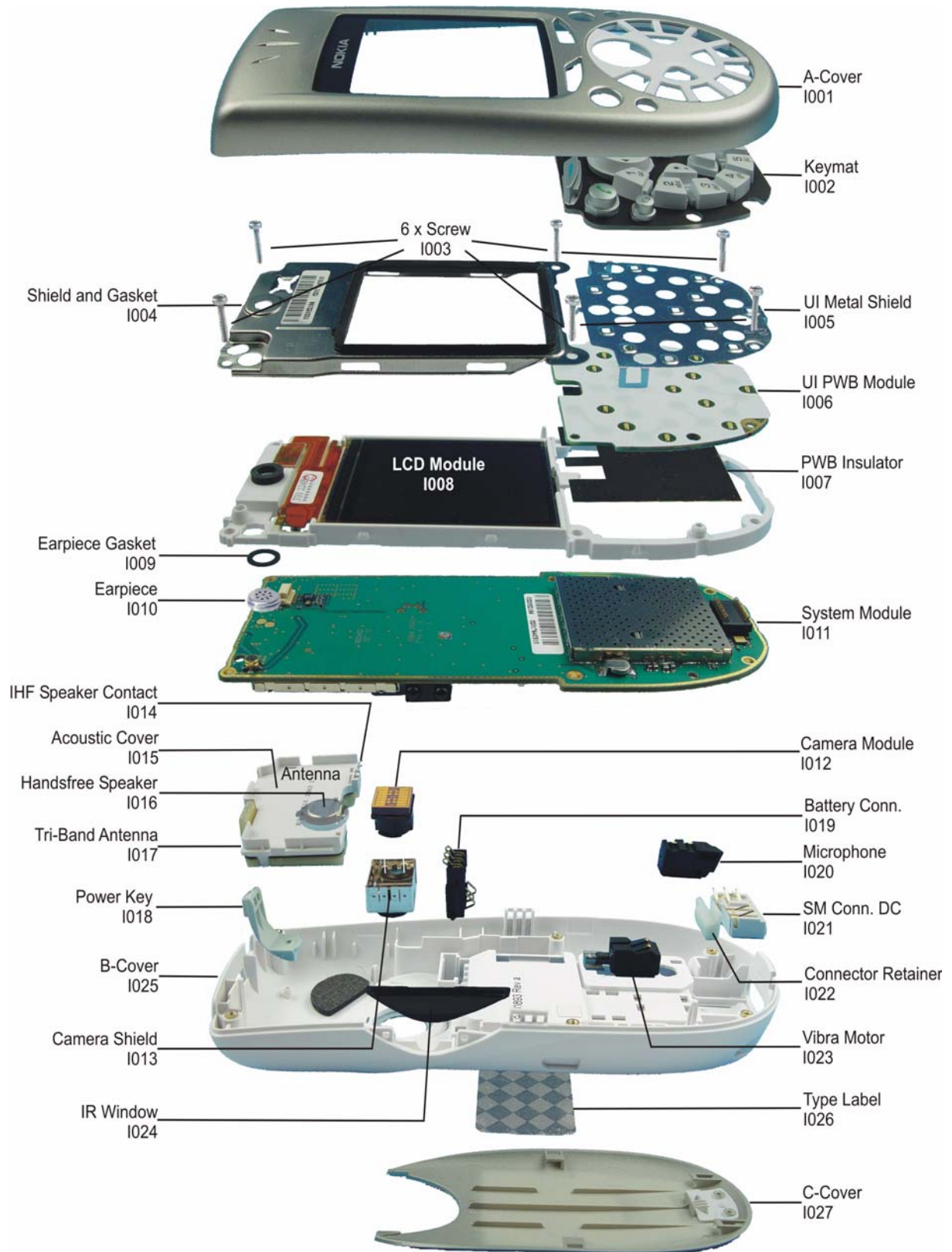

## Assembly Parts List

Item	Description	NMP code
I001	A Cover Blue	9458717
	A Cover Yellow	9458531
	A Cover Stay Silver	9458528
I002	Keymat (Latin)	9790661
	Keymat (Stroke)	9794099
	Keymat (Bopo)	9794098
I003	Screw x 6	6150091
I004	Shield and Gasket	9480895
I005	UI Metal Shield	9560252
I006	UI PWB Module	9480949
I007	PWB Insulator	9452603
I008	LCD Module	9458985
I009	Earpiece Gasket	9470260
I010	Earpiece	5140251
I011	CS7 System Module	0201764
I012	Camera Module	4858005
I013	Camera Shield	9560234
(I014 - I017) Antenna Module		9480892
I014	IHF Speaker Contact	*
I015	Acoustic Cover	*
I016	Handsfree Speaker	*
I017	Tri-Band Antenna	*
I018	Power Key	9452463
I019	Battery Connector	9400287
I020	Microphone Module	5140275
I021	SM Connector DC	5460101
I022	Connector Retainer	9470264
I023	Vibra Motor	6800041
I024	IR Window	9470266
I025	B Cover	9458824
I026	Type Label	9381282
I027	C Cover Blue	9458715
	C Cover Yellow	9458523
	C Cover Stay Silver	9458521

**Note: \* these items are not available as spare parts.**

## Parts List for NHM-10 Module

### PWB Components

Item	Product Code	Location			Description and value				Type
		Side,	Grid	ref.					
A100	9560210	Bot- tom	E	4	RF SHIELD ASSY DMC04207-EN P1188	~	~	~	SHIELD_DMD07823
A200	9560212	Bot- tom	E	8	PA SHIELD ASSY DMC04206-EN P1188	~	~	~	SHIELD_DMD07821
A300	9517217	Bot- tom	Q	5	SHIELD MOD BB DMC05496 P1188	~	~	~	SHIELD_DMC05496
A301	9560221	Top	T	6	RF SHIELD ASSY DMC04204-EN P1188	~	~	~	SHIELD_DMD07817
B190	4510303	Bot- tom	O	3	CRYSTAL 32.768KHZ+- 20PPM 12.5PF	32.768kHz	~	~	CRYSTAL_FC_255
B601	4510337	Bot- tom	C	3	CRYSTAL 26.0MHZ+- 10PPM CL=TBD	26MHz	~	~	CRYSTAL_TSX_8A
C100	2320805	Bot- tom	S	7	CHIPCAP X5R 100N K 10V 0402	100n	10V	normal,-10%,10%	0402C
C101	2320805	Bot- tom	R	7	CHIPCAP X5R 100N K 10V 0402	100n	10V	normal,-10%,10%	0402C
C102	2320805	Bot- tom	R	4	CHIPCAP X5R 100N K 10V 0402	100n	10V	normal,-10%,10%	0402C
C105	2320805	Bot- tom	U	5	CHIPCAP X5R 100N K 10V 0402	100n	10V	normal,-10%,10%	0402C
C107	2320805	Bot- tom	S	7	CHIPCAP X5R 100N K 10V 0402	100n	10V	normal,-10%,10%	0402C
C112	2320805	Bot- tom	T	4	CHIPCAP X5R 100N K 10V 0402	100n	10V	normal,-10%,10%	0402C
C113	2320805	Bot- tom	Q	5	CHIPCAP X5R 100N K 10V 0402	100n	10V	normal,-10%,10%	0402C
C114	2320805	Bot- tom	Q	6	CHIPCAP X5R 100N K 10V 0402	100n	10V	normal,-10%,10%	0402C
C115	2320805	Bot- tom	S	7	CHIPCAP X5R 100N K 10V 0402	100n	10V	normal,-10%,10%	0402C
C118	2320778	Bot- tom	T	7	Chipcap X7R 10% 16V 0402	10n	16V	normal,-10%,10%	0402C
C119	2320805	Bot- tom	S	7	CHIPCAP X5R 100N K 10V 0402	100n	10V	normal,-10%,10%	0402C
C120	2320805	Bot- tom	U	5	CHIPCAP X5R 100N K 10V 0402	100n	10V	normal,-10%,10%	0402C
C122	2320805	Bot- tom	T	7	CHIPCAP X5R 100N K 10V 0402	100n	10V	normal,-10%,10%	0402C
C130	2320805	Bot- tom	J	6	CHIPCAP X5R 100N K 10V 0402	100n	10V	normal,-10%,10%	0402C
C131	2320805	Bot- tom	G	6	CHIPCAP X5R 100N K 10V 0402	100n	10V	normal,-10%,10%	0402C

Item	Product Code	Location			Description and value				Type
		Side, Grid ref.							
C132	2320778	Bot- tom	N	7	Chipcap X7R 10% 16V 0402	10n	16V	normal,-10%,10%	0402C
C134	2320783	Bot- tom	0	2	CHIPCAP X7R 33N K 10V 0402	33n	10V	normal,-10%,10%	0402C
C135	2310793	Bot- tom	N	2	CHIPCAP X5R 2U2 K 10V 0805	2u2	10V	normal,-10%,10%	0805C
C136	2320778	Bot- tom	M	7	Chipcap X7R 10% 16V 0402	10n	16V	normal,-10%,10%	0402C
C137	2320778	Bot- tom	M	8	Chipcap X7R 10% 16V 0402	10n	16V	normal,-10%,10%	0402C
C138	2320778	Bot- tom	L	8	Chipcap X7R 10% 16V 0402	10n	16V	normal,-10%,10%	0402C
C139	2320778	Bot- tom	L	7	Chipcap X7R 10% 16V 0402	10n	16V	normal,-10%,10%	0402C
C140	2320805	Top	D	8	CHIPCAP X5R 100N K 10V 0402	100n	10V	normal,-10%,10%	0402C
C141	2320805	Top	D	8	CHIPCAP X5R 100N K 10V 0402	100n	10V	normal,-10%,10%	0402C
C143	2320778	Bot- tom	L	8	Chipcap X7R 10% 16V 0402	10n	16V	normal,-10%,10%	0402C
C161	2312243	Top	R	8	CHIPCAP X5R 4U7 K 6V3 0805	4u7	6V3	normal,-10%,10%	0805C
C164	2312411	Top	Q	8	CHIPCAP X5R 1U0 M 25V 1206	1u0	25V	normal,-20%,20%	1206_BLM
C165	2310037	Top	Q	7	CHIPCAP X5R 10U M 6V3 0805	10U	6V3	normal,-20%,20%	0805C
C166	2320481	Top	Q	6	CHIPCAP X5R 1U K 6V3 0603	1u0	6.3V	normal,-10%,10%	0603C
C167	2312257	Top	Q	7	CHIPCAP X7R 330N K 16V 0805	330n	16V	normal,-10%,10%	0805C
C168	2312257	Top	Q	5	CHIPCAP X7R 330N K 16V 0805	330n	16V	normal,-10%,10%	0805C
C169	2312411	Top	Q	8	CHIPCAP X5R 1U0 M 25V 1206	1u0	25V	normal,-20%,20%	1206_BLM
C170	2320552	Top	R	8	Chipcap 5% NP0	47p	50V	normal,-5%,5%	0402C
C171	2320536	Bot- tom	U	7	Chipcap 5% NP0	10p	50V	normal,-5%,5%	0402C
C172	2310037	Top	Q	5	CHIPCAP X5R 10U M 6V3 0805	10U	6V3	normal,-20%,20%	0805C
C190	2320481	Bot- tom	N	4	CHIPCAP X5R 1U K 6V3 0603	1u0	6.3V	normal,-10%,10%	0603C
C191	2320778	Bot- tom	N	4	Chipcap X7R 10% 16V 0402	10n	16V	normal,-10%,10%	0402C
C192	2320744	Bot- tom	N	4	Chipcap X7R 10% 50V 0402	1n0	50V	normal,-10%,10%	0402C
C194	2320481	Bot- tom	N	4	CHIPCAP X5R 1U K 6V3 0603	1u0	6.3V	normal,-10%,10%	0603C

Item	Product Code	Location			Description and value				Type
		Side, Grid ref.							
C196	2320536	Bot- tom	P	3	Chipcap 5% NP0	10p	50V	normal,-5%,5%	0402C
C197	2320536	Bot- tom	P	4	Chipcap 5% NP0	10p	50V	normal,-5%,5%	0402C
C198	2320481	Bot- tom	P	6	CHIPCAP X5R 1U K 6V3 0603	1u0	6.3V	normal,-10%,10%	0603C
C199	2320481	Bot- tom	L	4	CHIPCAP X5R 1U K 6V3 0603	1u0	6.3V	normal,-10%,10%	0603C
C201	2320805	Bot- tom	P	4	CHIPCAP X5R 100N K 10V 0402	100n	10V	normal,-10%,10%	0402C
C203	2320481	Bot- tom	O	4	CHIPCAP X5R 1U K 6V3 0603	1u0	6.3V	normal,-10%,10%	0603C
C204	2320481	Bot- tom	O	3	CHIPCAP X5R 1U K 6V3 0603	1u0	6.3V	normal,-10%,10%	0603C
C205	2320805	Bot- tom	O	4	CHIPCAP X5R 100N K 10V 0402	100n	10V	normal,-10%,10%	0402C
C207	2320544	Bot- tom	P	5	Chipcap 5% NP0	22p	50V	normal,-5%,5%	0402C
C209	2320544	Bot- tom	P	5	Chipcap 5% NP0	22p	50V	normal,-5%,5%	0402C
C211	2320544	Bot- tom	P	5	Chipcap 5% NP0	22p	50V	normal,-5%,5%	0402C
C213	2320544	Bot- tom	P	5	Chipcap 5% NP0	22p	50V	normal,-5%,5%	0402C
C215	2320805	Bot- tom	O	7	CHIPCAP X5R 100N K 10V 0402	100n	10V	normal,-10%,10%	0402C
C216	2320805	Bot- tom	N	7	CHIPCAP X5R 100N K 10V 0402	100n	10V	normal,-10%,10%	0402C
C218	2320805	Bot- tom	M	6	CHIPCAP X5R 100N K 10V 0402	100n	10V	normal,-10%,10%	0402C
C219	2320805	Bot- tom	M	6	CHIPCAP X5R 100N K 10V 0402	100n	10V	normal,-10%,10%	0402C
C223	2320805	Bot- tom	M	4	CHIPCAP X5R 100N K 10V 0402	100n	10V	normal,-10%,10%	0402C
C224	2320805	Bot- tom	M	4	CHIPCAP X5R 100N K 10V 0402	100n	10V	normal,-10%,10%	0402C
C226	2320744	Bot- tom	P	6	Chipcap X7R 10% 50V 0402	1n0	50V	normal,-10%,10%	0402C
C227	2320744	Bot- tom	O	7	Chipcap X7R 10% 50V 0402	1n0	50V	normal,-10%,10%	0402C
C228	2320744	Bot- tom	P	6	Chipcap X7R 10% 50V 0402	1n0	50V	normal,-10%,10%	0402C
C230	2320481	Bot- tom	M	5	CHIPCAP X5R 1U K 6V3 0603	1u0	6.3V	normal,-10%,10%	0603C
C232	2320805	Bot- tom	M	6	CHIPCAP X5R 100N K 10V 0402	100n	10V	normal,-10%,10%	0402C
C234	2320481	Bot- tom	M	5	CHIPCAP X5R 1U K 6V3 0603	1u0	6.3V	normal,-10%,10%	0603C

Item	Product Code	Location			Description and value				Type
		Side, Grid ref.							
C236	2320481	Bot- tom	L	6	CHIPCAP X5R 1U K 6V3 0603	1u0	6.3V	normal,-10%,10%	0603C
C240	2320481	Bot- tom	L	5	CHIPCAP X5R 1U K 6V3 0603	1u0	6.3V	normal,-10%,10%	0603C
C241	2320481	Bot- tom	N	3	CHIPCAP X5R 1U K 6V3 0603	1u0	6.3V	normal,-10%,10%	0603C
C242	2320481	Bot- tom	O	4	CHIPCAP X5R 1U K 6V3 0603	1u0	6.3V	normal,-10%,10%	0603C
C243	2320481	Bot- tom	P	7	CHIPCAP X5R 1U K 6V3 0603	1u0	6.3V	normal,-10%,10%	0603C
C244	2320481	Bot- tom	M	4	CHIPCAP X5R 1U K 6V3 0603	1u0	6.3V	normal,-10%,10%	0603C
C245	2320481	Bot- tom	O	7	CHIPCAP X5R 1U K 6V3 0603	1u0	6.3V	normal,-10%,10%	0603C
C246	2320481	Bot- tom	M	4	CHIPCAP X5R 1U K 6V3 0603	1u0	6.3V	normal,-10%,10%	0603C
C247	2320481	Bot- tom	O	3	CHIPCAP X5R 1U K 6V3 0603	1u0	6.3V	normal,-10%,10%	0603C
C249	2320481	Bot- tom	P	4	CHIPCAP X5R 1U K 6V3 0603	1u0	6.3V	normal,-10%,10%	0603C
C251	2320481	Bot- tom	L	6	CHIPCAP X5R 1U K 6V3 0603	1u0	6.3V	normal,-10%,10%	0603C
C252	2320544	Bot- tom	P	5	Chipcap 5% NP0	22p	50V	normal,-5%,5%	0402C
C254	2320544	Bot- tom	P	5	Chipcap 5% NP0	22p	50V	normal,-5%,5%	0402C
C255	2320481	Bot- tom	L	5	CHIPCAP X5R 1U K 6V3 0603	1u0	6.3V	normal,-10%,10%	0603C
C256	2320481	Bot- tom	M	6	CHIPCAP X5R 1U K 6V3 0603	1u0	6.3V	normal,-10%,10%	0603C
C257	2320481	Bot- tom	M	4	CHIPCAP X5R 1U K 6V3 0603	1u0	6.3V	normal,-10%,10%	0603C
C258	2320481	Bot- tom	L	5	CHIPCAP X5R 1U K 6V3 0603	1u0	6.3V	normal,-10%,10%	0603C
C259	2320481	Bot- tom	L	5	CHIPCAP X5R 1U K 6V3 0603	1u0	6.3V	normal,-10%,10%	0603C
C260	2320552	Top	R	7	Chipcap 5% NP0	47p	50V	normal,-5%,5%	0402C
C261	2310037	Top	R	7	CHIPCAP X5R 10U M 6V3 0805	10U	6V3	normal,-20%,20%	0805C
C263	2310037	Top	R	6	CHIPCAP X5R 10U M 6V3 0805	10U	6V3	normal,-20%,20%	0805C
C264	2320544	Bot- tom	P	5	Chipcap 5% NP0	22p	50V	normal,-5%,5%	0402C
C265	2320544	Bot- tom	P	5	Chipcap 5% NP0	22p	50V	normal,-5%,5%	0402C
C282	2312243	Top	S	9	CHIPCAP X5R 4U7 K 6V3 0805	4u7	6V3	normal,-10%,10%	0805C



Item	Product Code	Location			Description and value				Type
		Side, Grid ref.							
C283	2320481	Top	S	8	CHIPCAP X5R 1U K 6V3 0603	1u0	6.3V	normal,-10%,10%	0603C
C284	2310037	Top	R	6	CHIPCAP X5R 10U M 6V3 0805	10U	6V3	normal,-20%,20%	0805C
C290	2320481	Bot- tom	L	6	CHIPCAP X5R 1U K 6V3 0603	1u0	6.3V	normal,-10%,10%	0603C
C293	2320481	Bot- tom	L	6	CHIPCAP X5R 1U K 6V3 0603	1u0	6.3V	normal,-10%,10%	0603C
C300	2320481	Bot- tom	N	3	CHIPCAP X5R 1U K 6V3 0603	1u0	6.3V	normal,-10%,10%	0603C
C301	2320481	Bot- tom	M	5	CHIPCAP X5R 1U K 6V3 0603	1u0	6.3V	normal,-10%,10%	0603C
C302	2310037	Bot- tom	L	4	CHIPCAP X5R 10U M 6V3 0805	10U	6V3	normal,-20%,20%	0805C
C308	2320778	Top	Q	4	Chipcap X7R 10% 16V 0402	10n	16V	normal,-10%,10%	0402C
C310	2320805	Bot- tom	T	4	CHIPCAP X5R 100N K 10V 0402	100n	10V	normal,-10%,10%	0402C
C311	2320779	Top	S	3	CHIPCAP X7R 100N K 16V 0603	100n	16V	normal,-10%,10%	0603_BLM
C312	2320805	Bot- tom	R	3	CHIPCAP X5R 100N K 10V 0402	100n	10V	normal,-10%,10%	0402C
C313	2320481	Bot- tom	M	3	CHIPCAP X5R 1U K 6V3 0603	1u0	6.3V	normal,-10%,10%	0603C
C314	2320805	Bot- tom	R	4	CHIPCAP X5R 100N K 10V 0402	100n	10V	normal,-10%,10%	0402C
C315	2320805	Bot- tom	U	4	CHIPCAP X5R 100N K 10V 0402	100n	10V	normal,-10%,10%	0402C
C316	2320805	Bot- tom	T	3	CHIPCAP X5R 100N K 10V 0402	100n	10V	normal,-10%,10%	0402C
C318	2320778	Bot- tom	U	6	Chipcap X7R 10% 16V 0402	10n	16V	normal,-10%,10%	0402C
C319	2320778	Bot- tom	V	4	Chipcap X7R 10% 16V 0402	10n	16V	normal,-10%,10%	0402C
C320	2320805	Bot- tom	U	4	CHIPCAP X5R 100N K 10V 0402	100n	10V	normal,-10%,10%	0402C
C321	2320805	Bot- tom	U	5	CHIPCAP X5R 100N K 10V 0402	100n	10V	normal,-10%,10%	0402C
C322	2320805	Bot- tom	V	3	CHIPCAP X5R 100N K 10V 0402	100n	10V	normal,-10%,10%	0402C
C323	2320778	Bot- tom	V	7	Chipcap X7R 10% 16V 0402	10n	16V	normal,-10%,10%	0402C
C324	2320779	Bot- tom	P	3	CHIPCAP X7R 100N K 16V 0603	100n	16V	normal,-10%,10%	0603_BLM
C325	2320805	Bot- tom	P	5	CHIPCAP X5R 100N K 10V 0402	100n	10V	normal,-10%,10%	0402C
C326	2320778	Bot- tom	V	4	Chipcap X7R 10% 16V 0402	10n	16V	normal,-10%,10%	0402C

Item	Product Code	Location			Description and value				Type
		Side, Grid ref.							
C330	2320783	Bot- tom	P	6	CHIPCAP X7R 33N K 10V 0402	33n	10V	normal,-10%,10%	0402C
C331	2320783	Bot- tom	P	6	CHIPCAP X7R 33N K 10V 0402	33n	10V	normal,-10%,10%	0402C
C332	2320544	Bot- tom	V	8	Chipcap 5% NPO	22p	50V	normal,-5%,5%	0402C
C333	2320778	Bot- tom	P	6	Chipcap X7R 10% 16V 0402	10n	16V	normal,-10%,10%	0402C
C334	2320578	Top	R	3	Chipcap 5% X7R	560p	50V	normal,-5%,5%	0402C
C336	2320789	Top	R	3	CHIPCAP X5R 12N K 16V 0402	12n0	16V	normal,-10%,10%	0402C
C337	2320789	Top	R	3	CHIPCAP X5R 12N K 16V 0402	12n0	16V	normal,-10%,10%	0402C
C338	2320544	Bot- tom	I	8	Chipcap 5% NPO	22p	50V	normal,-5%,5%	0402C
C339	2320481	Top	R	4	CHIPCAP X5R 1U K 6V3 0603	1u0	6.3V	normal,-10%,10%	0603C
C340	2320544	Bot- tom	I	9	Chipcap 5% NPO	22p	50V	normal,-5%,5%	0402C
C341	2320544	Bot- tom	I	9	Chipcap 5% NPO	22p	50V	normal,-5%,5%	0402C
C342	2320805	Top	Q	3	CHIPCAP X5R 100N K 10V 0402	100n	10V	normal,-10%,10%	0402C
C343	2320544	Bot- tom	V	8	Chipcap 5% NPO	22p	50V	normal,-5%,5%	0402C
C344	2320544	Bot- tom	V	7	Chipcap 5% NPO	22p	50V	normal,-5%,5%	0402C
C345	2320783	Bot- tom	Q	5	CHIPCAP X7R 33N K 10V 0402	33n	10V	normal,-10%,10%	0402C
C346	2320783	Bot- tom	Q	5	CHIPCAP X7R 33N K 10V 0402	33n	10V	normal,-10%,10%	0402C
C347	2320544	Bot- tom	W	6	Chipcap 5% NPO	22p	50V	normal,-5%,5%	0402C
C348	2320778	Bot- tom	P	5	Chipcap X7R 10% 16V 0402	10n	16V	normal,-10%,10%	0402C
C350	2320744	Bot- tom	Q	5	Chipcap X7R 10% 50V 0402	1n0	50V	normal,-10%,10%	0402C
C351	2320744	Bot- tom	Q	5	Chipcap X7R 10% 50V 0402	1n0	50V	normal,-10%,10%	0402C
C352	2320544	Bot- tom	W	5	Chipcap 5% NPO	22p	50V	normal,-5%,5%	0402C
C353	2320544	Bot- tom	W	6	Chipcap 5% NPO	22p	50V	normal,-5%,5%	0402C
C354	2320544	Top	B	7	Chipcap 5% NPO	22p	50V	normal,-5%,5%	0402C
C355	2320544	Top	B	7	Chipcap 5% NPO	22p	50V	normal,-5%,5%	0402C
C356	2320544	Top	C	7	Chipcap 5% NPO	22p	50V	normal,-5%,5%	0402C

Item	Product Code	Location			Description and value				Type
		Side, Grid ref.							
C357	2320778	Bot- tom	Q	5	Chipcap X7R 10% 16V 0402	10n	16V	normal,-10%,10%	0402C
C360	2320805	Bot- tom	K	3	CHIPCAP X5R 100N K 10V 0402	100n	10V	normal,-10%,10%	0402C
C362	2320544	Bot- tom	J	2	Chipcap 5% NPO	22p	50V	normal,-5%,5%	0402C
C363	2320137	Bot- tom	J	3	CHIPCAP X5R 470N K 10V 0603	470n	10V	normal,-10%,10%	0603C
C386	2320481	Bot- tom	J	9	CHIPCAP X5R 1U K 6V3 0603	1u0	6.3V	normal,-10%,10%	0603C
C430	2320481	Top	U	10	CHIPCAP X5R 1U K 6V3 0603	1u0	6.3V	normal,-10%,10%	0603C
C431	2320481	Top	T	2	CHIPCAP X5R 1U K 6V3 0603	1u0	6.3V	normal,-10%,10%	0603C
C432	2320481	Top	T	2	CHIPCAP X5R 1U K 6V3 0603	1u0	6.3V	normal,-10%,10%	0603C
C471	2320805	Bot- tom	R	9	CHIPCAP X5R 100N K 10V 0402	100n	10V	normal,-10%,10%	0402C
C485	2320805	Bot- tom	P	9	CHIPCAP X5R 100N K 10V 0402	100n	10V	normal,-10%,10%	0402C
C489	2320481	Bot- tom	P	8	CHIPCAP X5R 1U K 6V3 0603	1u0	6.3V	normal,-10%,10%	0603C
C490	2310793	Bot- tom	P	7	CHIPCAP X5R 2U2 K 10V 0805	2u2	10V	normal,-10%,10%	0805C
C491	2320778	Bot- tom	O	8	Chipcap X7R 10% 16V 0402	10n	16V	normal,-10%,10%	0402C
C602	2320546	Bot- tom	L	4	Chipcap 5% NPO	27p	50V	normal,-5%,5%	0402C
C603	2320744	Bot- tom	L	3	Chipcap X7R 10% 50V 0402	1n0	50V	normal,-10%,10%	0402C
C604	2320629	Bot- tom	D	5	CHIPCAP NPO 1P0 B 50V 0402	1p0	50V	normal,-0.1p,0.1p	0402C
C605	2320805	Bot- tom	C	4	CHIPCAP X5R 100N K 10V 0402	100n	10V	normal,-10%,10%	0402C
C606	2320546	Bot- tom	C	4	Chipcap 5% NPO	27p	50V	normal,-5%,5%	0402C
C607	2312211	Bot- tom	C	5	CHIPCAP X5R 3U3 K 6V3 0805	3u3	6V3	normal,-10%,10%	0805C_H1.35
C610	2320805	Bot- tom	H	3	CHIPCAP X5R 100N K 10V 0402	100n	10V	normal,-10%,10%	0402C
C615	2320778	Bot- tom	C	4	Chipcap X7R 10% 16V 0402	10n	16V	normal,-10%,10%	0402C
C620	2320546	Bot- tom	D	4	Chipcap 5% NPO	27p	50V	normal,-5%,5%	0402C
C622	2320805	Bot- tom	F	4	CHIPCAP X5R 100N K 10V 0402	100n	10V	normal,-10%,10%	0402C
C623	2320778	Bot- tom	E	2	Chipcap X7R 10% 16V 0402	10n	16V	normal,-10%,10%	0402C

Item	Product Code	Location			Description and value				Type
		Side, Grid ref.							
C624	2320618	Bot- tom	E	3	Chipcap X7R 5% 25V 0402	4n7	25V	normal,-5%,5%	0402C
C625	2320481	Bot- tom	E	2	CHIPCAP X5R 1U K 6V3 0603	1u0	6.3V	normal,-10%,10%	0603C
C626	2320522	Bot- tom	F	3	Chipcap +-0.25pF NPO	2p7	50V	normal,- 0.25pF,0.25pF	0402C
C627	2312243	Bot- tom	F	3	CHIPCAP X5R 4U7 K 6V3 0805	4u7	6V3	normal,-10%,10%	0805C
C628	2320805	Bot- tom	D	3	CHIPCAP X5R 100N K 10V 0402	100n	10V	normal,-10%,10%	0402C
C629	2320546	Bot- tom	E	3	Chipcap 5% NPO	27p	50V	normal,-5%,5%	0402C
C632	2320744	Bot- tom	D	4	Chipcap X7R 10% 50V 0402	1n0	50V	normal,-10%,10%	0402C
C633	2320546	Bot- tom	E	2	Chipcap 5% NPO	27p	50V	normal,-5%,5%	0402C
C634	2320520	Bot- tom	D	5	Chipcap +-0.25pF NPO	2p2	50V	normal,- 0.25pF,0.25pF	0402C
C635	2320805	Bot- tom	E	2	CHIPCAP X5R 100N K 10V 0402	100n	10V	normal,-10%,10%	0402C
C706	2320564	Bot- tom	F	3	Chipcap 5% NPO	150p	50V	normal,-5%,5%	0402C
C710	2321013	Bot- tom	G	2	CHIPCAP NPO 270P J 25V 0402	270p	25V	normal,-5%,5%	0402C
C711	2420031	Bot- tom	G	3	CHIPCAP PPS 2N7 G 16V 0603	2n7	16V	normal,-2%,2%	0603C
C712	2320631	Bot- tom	G	2	CHIPCAP NPO 180P J 25V 0402	180p	25V	normal,-5%,5%	0402C
C715	2320556	Bot- tom	F	3	Chipcap 5% NPO	68p	50V	normal,-5%,5%	0402C
C716	2320556	Bot- tom	F	3	Chipcap 5% NPO	68p	50V	normal,-5%,5%	0402C
C717	2320546	Bot- tom	F	2	Chipcap 5% NPO	27p	50V	normal,-5%,5%	0402C
C718	2320744	Bot- tom	F	2	Chipcap X7R 10% 50V 0402	1n0	50V	normal,-10%,10%	0402C
C721	2320744	Bot- tom	F	4	Chipcap X7R 10% 50V 0402	1n0	50V	normal,-10%,10%	0402C
C722	2320540	Bot- tom	F	5	Chipcap 5% NPO	15p	50V	normal,-5%,5%	0402C
C723	2320544	Bot- tom	E	7	Chipcap 5% NPO	22p	50V	normal,-5%,5%	0402C
C724	2320629	Bot- tom	E	7	CHIPCAP NPO 1P0 B 50V 0402	1p0	50V	normal,-0.1p,0.1p	0402C
C729	2320602	Bot- tom	E	6	Chipcap +-0.25pF NPO	4p7	50V	normal,- 0.25pF,0.25pF	0402C
C731	2320546	Bot- tom	F	4	Chipcap 5% NPO	27p	50V	normal,-5%,5%	0402C

Item	Product Code	Location			Description and value				Type
		Side, Grid ref.							
C735	2320530	Bot- tom	F	6	Chipcap +-0.25pF NPO	5p6	50V	normal,- 0.25pF,0.25pF	0402C
C736	2320536	Bot- tom	F	7	Chipcap 5% NPO	10p	50V	normal,-5%,5%	0402C
C740	2312211	Bot- tom	G	4	CHIPCAP X5R 3U3 K 6V3 0805	3u3	6V3	normal,-10%,10%	0805C_H1.35
C741	2320602	Bot- tom	G	3	Chipcap +-0.25pF NPO	4p7	50V	normal,- 0.25pF,0.25pF	0402C
C744	2320744	Bot- tom	F	7	Chipcap X7R 10% 50V 0402	1n0	50V	normal,-10%,10%	0402C
C803	2320546	Bot- tom	C	7	Chipcap 5% NPO	27p	50V	normal,-5%,5%	0402C
C804	2320552	Bot- tom	C	7	Chipcap 5% NPO	47p	50V	normal,-5%,5%	0402C
C805	2320546	Bot- tom	C	6	Chipcap 5% NPO	27p	50V	normal,-5%,5%	0402C
C818	2320548	Bot- tom	G	7	Chipcap 5% NPO	33p	50V	normal,-5%,5%	0402C
C820	2320546	Bot- tom	F	7	Chipcap 5% NPO	27p	50V	normal,-5%,5%	0402C
C821	2320518	Bot- tom	F	7	Chipcap +-0.25pF NPO	1p8	50V	normal,- 0.25pF,0.25pF	0402C
C822	2320546	Bot- tom	F	6	Chipcap 5% NPO	27p	50V	normal,-5%,5%	0402C
C824	2320532	Bot- tom	G	6	Chipcap +-0.25pF NPO	6p8	50V	normal,- 0.25pF,0.25pF	0402C
C826	2320534	Bot- tom	D	8	Chipcap +-0.25pF NPO	8p2	50V	normal,- 0.25pF,0.25pF	0402C
C871	2320805	Bot- tom	D	4	CHIPCAP X5R 100N K 10V 0402	100n	10V	normal,-10%,10%	0402C
C872	2611731	Bot- tom	H	10	CHIPTCAP 100U M 16V 7.3X4.3X2.0	100u_16V	16V	normal,-20%,20%	TANT_TAJY
C873	2320744	Bot- tom	D	9	Chipcap X7R 10% 50V 0402	1n0	50V	normal,-10%,10%	0402C
C874	2320602	Bot- tom	D	9	Chipcap +-0.25pF NPO	4p7	50V	normal,- 0.25pF,0.25pF	0402C
C876	2320744	Bot- tom	G	7	Chipcap X7R 10% 50V 0402	1n0	50V	normal,-10%,10%	0402C
C877	2320548	Bot- tom	D	9	Chipcap 5% NPO	33p	50V	normal,-5%,5%	0402C
C878	2320536	Bot- tom	D	10	Chipcap 5% NPO	10p	50V	normal,-5%,5%	0402C
C880	2310793	Bot- tom	D	9	CHIPCAP X5R 2U2 K 10V 0805	2u2	10V	normal,-10%,10%	0805C
C881	2320546	Bot- tom	D	10	Chipcap 5% NPO	27p	50V	normal,-5%,5%	0402C
C882	2322023	Bot- tom	F	3	CHIPCAP NPO 2N2 J 16V 0603	2n2	16V	normal,-5%,5%	0603C

Item	Product Code	Location			Description and value				Type
		Side,	Grid	ref.					
D100	4370943	Bot- tom	S	6	UPP_WD2-V2.4 F741973F UBGA240	~	~	~	CSP_240
D103	4370955	Bot- tom	M	7	HW ACCELERATOR STV0900V3.2 6X6BGA	~	~	~	uBGA_56
D135	4341309	Top	R	8	DC/DC CONV 350MA TK11851 SSOP8	~	~	~	SOT23L_8
D190	4370825	Bot- tom	N	5	UEMK 4.4 W-DOG ENA TO21 TFBGA168	~	~	~	uBGA168
D310	4341381	Bot- tom	Q	4	FLASH 4MX16 1V8/1V8 VTFBGA44**FOR AMD ONLY**	4Mx16	~	~	VTFBGA44
D311	4341381	Bot- tom	S	4	FLASH 4MX16 1V8/1V8 VTFBGA44**FOR AMD ONLY**	4Mx16	~	~	VTFBGA44
D312	4341341	Bot- tom	U	6	SDRAM 4MX16 3.0/1.8V WBGA52	4Mx16	~	~	uBGA52_H1.1
D313	4341381	Bot- tom	U	4	FLASH 4MX16 1V8/1V8 VTFBGA44**FOR AMD ONLY**	4Mx16	~	~	VTFBGA44
F380	5119019	Bot- tom	Y	4	SM FUSE F 1.5A 32V 0603	1.5A	~	~	0603_FUSE
G190	4700801	Top	R	2	BATTERY LI-ION 0.14MAH 3V RB414	3.0V	~	~	BATTER_RB414
G701	4350391	Bot- tom	H	3	VCO 3290-3980MHZ 2.7V 20MA	3290- 3980MHz	~	~	VCO_FDK_IT_4
L130	3640145	Top	Q	9	CHOKE 15U +-30% 0R3 0.45A 3.8X3.8	15uH	~	normal,-30%,30%	CHOKE_CDRH3D16
L294	3640139	Top	S	7	CHOKE 10U M 0.69A 0R18 4X4X1.8	10uH	~	normal,-20%,20%	CHOKE_ELL4LM100 MN_CAMERON
L380	3203705	Bot- tom	W	4	FERRITE BEAD 42R/ 100MHZ 0805	42R/ 100MHz	~	~	0805_FERRITE
L381	3203743	Bot- tom	I	10	FERR.BEAD 0R03 42R/ 100MHZ 3A 0805	42R/ 100MHz	~	~	0805_BLM21
L430	3203701	Top	T	2	FERRITE BEAD 33R/ 100MHZ 0805	33R/ 100MHz	~	~	0805_FERRITE
L431	3203719	Top	S	2	FERRITE BEAD 05R 600R/ 100MHZ 0603	600R/ 100MHz	~	~	FERRITE_BK1608
L606	3646055	Bot- tom	D	5	CHIP COIL 8N2 J Q28/ 800MHZ 0402	8n2H	~	normal,-5%,+5%	0402L
L607	3646055	Bot- tom	D	5	CHIP COIL 8N2 J Q28/ 800MHZ 0402	8n2H	~	normal,-5%,+5%	0402L
L608	3646005	Bot- tom	E	5	CHIP COIL 2N7+-0N3 Q29/ 800M 0402	2n7H	~	normal,-0n3,0n3	0402L
L609	3646005	Bot- tom	D	5	CHIP COIL 2N7+-0N3 Q29/ 800M 0402	2n7H	~	normal,-0n3,0n3	0402L
L700	3646055	Bot- tom	E	7	CHIP COIL 8N2 J Q28/ 800MHZ 0402	8n2H	~	normal,-5%,+5%	0402L
L701	3646047	Bot- tom	E	6	CHIP COIL 3N3 +-0N3 Q28/800M 0402	3n3H	~	normal,- 0n3,+0n3%	0402L

Item	Product Code	Location			Description and value				Type
		Side,	Grid	ref.					
L703	3646027	Bot- tom	C	2	CHIP COIL 33N J Q7/ 100MHZ 0402	33nH	~	normal,-5%,+5%	0402_ELJRF
L705	3646005	Bot- tom	F	5	CHIP COIL 2N7+-0N3 Q29/ 800M 0402	2n7H	~	normal,-0n3,0n3	0402L
L706	3646065	Bot- tom	F	4	CHIP COIL 12N J Q31/ 800M 0402	12nH	~	normal,-5%,5%	0402L
L707	3646067	Bot- tom	F	4	CHIP COIL 18N J Q29/ 800M 0402	18nH	~	normal,-5%,5%	0402L
L708	3646067	Bot- tom	F	4	CHIP COIL 18N J Q29/ 800M 0402	18nH	~	normal,-5%,5%	0402L
L711	3646063	Bot- tom	G	5	CHIP COIL 22N J Q28/ 800M 0402	22nH	~	normal,-5%,5%	0402L
L712	3646053	Bot- tom	F	5	CHIP COIL 4N7 +-0N3 Q28/800M 0402	4n7H	~	normal,-0n3,+0n3	0402L
L801	4550197	Bot- tom	C	8	DIR.COULER 850/1800/ 1900 2.1X1.35	850/1800/ 1900MHZ	~	~	COUPLER_LDC15D
L806	3646009	Bot- tom	F	7	CHIP COIL 10N J Q30/ 800M 0402	10nH	~	normal,-5%,5%	0402L
L807	3646059	Bot- tom	F	6	CHIP COIL 5N6 +-0N3 Q28/800M 0402	5n6H	~	normal,-0n1,+0n1	0402L
L812	1430718	Bot- tom	E	7	Resistor 5% 63mW	47R	~	normal,-5%,5%	0402R
L813	3646027	Bot- tom	C	3	CHIP COIL 33N J Q7/ 100MHZ 0402	33nH	~	normal,-5%,+5%	0402_ELJRF
N102	4341137	Top	Q	6	DC/DC CONV LM3353 4.1V 80MA MSOP10	~	~	~	MSOP_10
N261	4341505	Top	Q	7	DC/DC 1.8V/1.5V LM2608- 1.8 USMD10	~	~	~	USMD10_2.534X2.2 8X0.675
N262	4341519	Top	S	9	REG LP3987ITL-2.85 150MA USMD5	~	2.85V	~	USMD5_1.468X1.03 6
N263	4341421	Bot- tom	L	6	REG 2.8V 150MA LP3985ITLX USMD5	~	2.8V	~	USMD5_1.47X1.04_ H0.675
N301	4341535	Bot- tom	J	9	CURRENT SENSOR LM3819 USMD10	~	~	~	USMD_10_2.08X1.5 7
N330	4341429	Top	R	4	AF AMP 0.4W/2.6V LM4890ITLX USMD9	~	~	~	USMD9_1.544X1.54 4_0.675
N401	4341461	Bot- tom	P	8	VREG & LEVEL SHIFT LP3928 USMD16	~	3-6V	~	USMD16_2.03X2.03
N430	437F027	Top	U	6	BLUETOOTH LRB-4 MOD- ULE D560	~	~	~	BT102_X_BLUETOOT H
N431	4219941	Top	T	10	TRX2+RX4 RN4906 N&P 4.7k/47k US6	~	~	~	SOT_363
N601	4370867	Bot- tom	E	4	MJOELNER RF ASIC S2006 LFBGA80	~	~	~	LFBGA_80
N801	4350347	Bot- tom	E	9	PW AMP RF3132 GSM850/ 1900 3.5V	~	~	~	RF3132
R100	1430690	Top	W	3	Chipres 0W06 jumper 0402	OR	~	normal,-,-	0402R

Item	Product Code	Location			Description and value				Type
		Side,	Grid	ref.					
R118	1430786	Bot- tom	Q	5	Resistor 5% 63mW	18k	~	normal,-5%,5%	0402R
R130	1430804	Bot- tom	O	8	Resistor 5% 63mW	100k	~	normal,-5%,5%	0402R
R132	1430690	Bot- tom	B	8	Chipres 0W06 jumper 0402	0R	~	normal,-,-	0402R
R133	1825133	Bot- tom	B	8	CHIP VARISTOR VWM14V VC50V 0402	14V/50V	~	-	0402_VAR
R134	1430770	Bot- tom	N	8	Resistor 5% 63mW	4k7	~	normal,-5%,5%	0402R
R135	1430770	Bot- tom	M	8	Resistor 5% 63mW	4k7	~	normal,-5%,5%	0402R
R136	1430726	Bot- tom	Q	5	Resistor 5% 63mW	100R	~	normal,-5%,5%	0402R
R137	1430726	Bot- tom	Q	5	Resistor 5% 63mW	100R	~	normal,-5%,5%	0402R
R138	1430778	Bot- tom	M	7	Resistor 5% 63mW	10k	~	normal,-5%,5%	0402R
R139	1430784	Bot- tom	L	7	Resistor 5% 63mW	15k	~	normal,-5%,5%	0402R
R140	1430766	Bot- tom	M	6	Resistor 5% 63mW	3k9	~	normal,-5%,5%	0402R
R141	1430770	Bot- tom	K	6	Resistor 5% 63mW	4k7	~	normal,-5%,5%	0402R
R142	1430770	Bot- tom	K	6	Resistor 5% 63mW	4k7	~	normal,-5%,5%	0402R
R143	1430726	Bot- tom	L	6	Resistor 5% 63mW	100R	~	normal,-5%,5%	0402R
R144	1430726	Bot- tom	L	7	Resistor 5% 63mW	100R	~	normal,-5%,5%	0402R
R145	1430169	Top	P	4	Resistor 5% 63mW	56R	~	normal,-5%,+5%	0603R
R148	1430690	Bot- tom	M	6	Chipres 0W06 jumper 0402	0R	~	normal,-,-	0402R
R165	1430716	Top	Q	7	Resistor 5% 63mW	39R	~	normal,-5%,5%	0402R
R171	1430726	Bot- tom	T	7	Resistor 5% 63mW	100R	~	normal,-5%,5%	0402R
R174	1430754	Top	Q	7	Resistor 5% 63mW	1k0	~	normal,-5%,5%	0402R
R175	1430804	Top	Q	6	Resistor 5% 63mW	100k	~	normal,-5%,5%	0402R
R191	1414605	Bot- tom	N	3	CHIPRES 0W25 0R22 J 0805	0R22	~	normal,-5%,5%	0805R
R196	1430690	Top	Y	4	Chipres 0W06 jumper 0402	0R	~	normal,-,-	0402R
R214	1430690	Bot- tom	N	7	Chipres 0W06 jumper 0402	0R	~	normal,-,-	0402R
R217	1430145	Bot- tom	O	7	Chipres 0W06 100k F 200ppm 0402	100k	~	normal,-1%,1%	0402R
R218	1430804	Bot- tom	P	7	Resistor 5% 63mW	100k	~	normal,-5%,5%	0402R



Item	Product Code	Location			Description and value				Type
		Side, Grid ref.							
R219	1430804	Bot- tom	P	7	Resistor 5% 63mW	100k	~	normal,-5%,5%	0402R
R220	1430804	Bot- tom	P	6	Resistor 5% 63mW	100k	~	normal,-5%,5%	0402R
R228	1430873	Bot- tom	M	6	CHIPRES 0W06 27K F 0402	27k	~	normal,-1%,1%	0402R
R229	1825133	Bot- tom	U	9	CHIP VARISTOR VWM14V VC50V 0402	14V/50V	~	-	0402_VAR
R230	4120011	Bot- tom	U	8	ZDIX4 IP4043CX5 CA 14V2 10W CSP5	~	~	~	uBGA5
R231	1430690	Bot- tom	P	6	Chipres 0W06 jumper 0402	0R	~	normal,-,-	0402R
R232	1430690	Bot- tom	P	6	Chipres 0W06 jumper 0402	0R	~	normal,-,-	0402R
R233	1430690	Bot- tom	P	5	Chipres 0W06 jumper 0402	0R	~	normal,-,-	0402R
R234	1430690	Bot- tom	P	5	Chipres 0W06 jumper 0402	0R	~	normal,-,-	0402R
R235	1820039	Top	E	7	NTC RES 47K J B=4050+- 3% 0402	47k	~	normal,-5%,5%	0402_NTH5
R263	1430690	Top	R	7	Chipres 0W06 jumper 0402	0R	~	normal,-,-	0402R
R265	1430690	Top	Q	6	Chipres 0W06 jumper 0402	0R	~	normal,-,-	0402R
R266	1430690	Top	S	8	Chipres 0W06 jumper 0402	0R	~	normal,-,-	0402R
R300	1412286	Top	Q	4	Resistor 5% 63mW	0R	~	normal,-5%,5%	0805R
R301	1412286	Top	Q	4	Resistor 5% 63mW	0R	~	normal,-5%,5%	0805R
R314	1430770	Bot- tom	P	3	Resistor 5% 63mW	4k7	~	normal,-5%,5%	0402R
R315	1430690	Bot- tom	U	8	Chipres 0W06 jumper 0402	0R	~	normal,-,-	0402R
R330	1430754	Bot- tom	P	6	Resistor 5% 63mW	1k0	~	normal,-5%,5%	0402R
R331	1430690	Bot- tom	Q	6	Chipres 0W06 jumper 0402	0R	~	normal,-,-	0402R
R332	1430754	Bot- tom	Q	6	Resistor 5% 63mW	1k0	~	normal,-5%,5%	0402R
R336	1430790	Top	R	3	Resistor 5% 63mW	27k	~	normal,-5%,5%	0402R
R337	1430788	Top	R	4	Resistor 5% 63mW	22k	~	normal,-5%,5%	0402R
R338	1430788	Top	Q	3	Resistor 5% 63mW	22k	~	normal,-5%,5%	0402R
R339	1430788	Top	R	4	Resistor 5% 63mW	22k	~	normal,-5%,5%	0402R
R340	1825133	Bot- tom	I	8	CHIP VARISTOR VWM14V VC50V 0402	14V/50V	~	-	0402_VAR
R341	1825133	Bot- tom	I	9	CHIP VARISTOR VWM14V VC50V 0402	14V/50V	~	-	0402_VAR
R342	1430151	Bot- tom	V	8	Resistor 5% 100mW	10R	~	normal,-5%,+5%	0603R
R343	1430754	Bot- tom	Q	5	Resistor 5% 63mW	1k0	~	normal,-5%,5%	0402R

Item	Product Code	Location			Description and value				Type
		Side, Grid ref.							
R344	1430762	Bot- tom	Q	5	Resistor 5% 63mW	2k2	~	normal,-5%,5%	0402R
R345	1430762	Bot- tom	Q	6	Resistor 5% 63mW	2k2	~	normal,-5%,5%	0402R
R346	1430690	Bot- tom	Q	6	Chipres 0W06 jumper 0402	0R	~	normal,-,-	0402R
R347	1430754	Bot- tom	Q	6	Resistor 5% 63mW	1k0	~	normal,-5%,5%	0402R
R348	1825133	Bot- tom	V	7	CHIP VARISTOR VWM14V VC50V 0402	14V/50V	~	-	0402_VAR
R349	1825133	Bot- tom	V	8	CHIP VARISTOR VWM14V VC50V 0402	14V/50V	~	-	0402_VAR
R351	1825133	Bot- tom	W	8	CHIP VARISTOR VWM14V VC50V 0402	14V/50V	~	-	0402_VAR
R352	1825133	Bot- tom	W	5	CHIP VARISTOR VWM14V VC50V 0402	14V/50V	~	-	0402_VAR
R353	1825133	Bot- tom	W	6	CHIP VARISTOR VWM14V VC50V 0402	14V/50V	~	-	0402_VAR
R354	1825133	Top	B	7	CHIP VARISTOR VWM14V VC50V 0402	14V/50V	~	-	0402_VAR
R355	1825133	Top	B	7	CHIP VARISTOR VWM14V VC50V 0402	14V/50V	~	-	0402_VAR
R357	1430690	Top	B	7	Chipres 0W06 jumper 0402	0R	~	normal,-,-	0402R
R358	1430690	Top	B	7	Chipres 0W06 jumper 0402	0R	~	normal,-,-	0402R
R361	1430754	Bot- tom	Q	5	Resistor 5% 63mW	1k0	~	normal,-5%,5%	0402R
R362	1430695	Bot- tom	K	3	CHIPRES 0W06 6R8 J 0402	6R8	~	normal,-5%,5%	0402R
R363	1430695	Bot- tom	K	3	CHIPRES 0W06 6R8 J 0402	6R8	~	normal,-5%,5%	0402R
R364	1430695	Bot- tom	K	3	CHIPRES 0W06 6R8 J 0402	6R8	~	normal,-5%,5%	0402R
R365	1430695	Bot- tom	K	3	CHIPRES 0W06 6R8 J 0402	6R8	~	normal,-5%,5%	0402R
R366	1430804	Bot- tom	J	3	Resistor 5% 63mW	100k	~	normal,-5%,5%	0402R
R369	1430732	Bot- tom	J	3	Resistor 5% 63mW	180R	~	normal,-5%,5%	0402R
R383	1430762	Bot- tom	J	9	Resistor 5% 63mW	2k2	~	normal,-5%,5%	0402R
R384	1430762	Bot- tom	J	10	Resistor 5% 63mW	2k2	~	normal,-5%,5%	0402R
R385	4120011	Bot- tom	J	8	ZDIX4 IP4043CX5 CA 14V2 10W CSP5	~	~	~	uBGA5
R402	1430812	Bot- tom	U	8	Resistor 5% 63mW	220k	~	normal,-5%,5%	0402R
R404	1820039	Bot- tom	U	10	NTC RES 47K J B=4050+- 3% 0402	47k	~	normal,-5%,5%	0402_NTH5

Item	Product Code	Location			Description and value				Type
		Side, Grid ref.							
R430	1430690	Top	W	4	Chipres 0W06 jumper 0402	OR	~	normal,-,-	0402R
R432	1430690	Top	W	5	Chipres 0W06 jumper 0402	OR	~	normal,-,-	0402R
R434	1430796	Top	T	10	Resistor 5% 63mW	47k	~	normal,-5%,5%	0402R
R435	1430766	Top	T	10	Resistor 5% 63mW	3k9	~	normal,-5%,5%	0402R
R437	1430690	Top	S	6	Chipres 0W06 jumper 0402	OR	~	normal,-,-	0402R
R472	4120101	Bottom	O	8	ASIP MMC-INTERFACE ESD FILT BGA11	~	~	~	uBGA11_1.77X2.32
R489	1430690	Bottom	T	8	Chipres 0W06 jumper 0402	OR	~	normal,-,-	0402R
R490	1430690	Bottom	U	8	Chipres 0W06 jumper 0402	OR	~	normal,-,-	0402R
R496	4120071	Bottom	S	9	ASIP EMIF03-SIM01 SIM FILTER BGA8	~	~	~	uBGA8
R601	1430754	Bottom	M	3	Resistor 5% 63mW	1k0	~	normal,-5%,5%	0402R
R602	1430804	Bottom	L	4	Resistor 5% 63mW	100k	~	normal,-5%,5%	0402R
R603	1430804	Bottom	L	3	Resistor 5% 63mW	100k	~	normal,-5%,5%	0402R
R605	1430812	Bottom	D	2	Resistor 5% 63mW	220k	~	normal,-5%,5%	0402R
R610	1430712	Bottom	C	4	Resistor 5% 63mW	27R	~	normal,-5%,5%	0402R
R612	1430754	Bottom	C	4	Resistor 5% 63mW	1k0	~	normal,-5%,5%	0402R
R623	1430726	Bottom	E	2	Resistor 5% 63mW	100R	~	normal,-5%,5%	0402R
R626	1430846	Bottom	C	3	Resistor 1% 63mW	2k7	~	normal,-1%,1%	0402R
R627	1430718	Bottom	M	3	Resistor 5% 63mW	47R	~	normal,-5%,5%	0402R
R630	1430718	Bottom	D	3	Resistor 5% 63mW	47R	~	normal,-5%,5%	0402R
R706	1430788	Bottom	F	3	Resistor 5% 63mW	22k	~	normal,-5%,5%	0402R
R707	1430784	Bottom	F	2	Resistor 5% 63mW	15k	~	normal,-5%,5%	0402R
R708	1430766	Bottom	F	3	Resistor 5% 63mW	3k9	~	normal,-5%,5%	0402R
R710	1430841	Bottom	G	3	Chipres 0W06 6k8 F 0402	6k8	~	normal,-1%,1%	0402R
R711	1430865	Bottom	G	2	CHIPRES 0W06 5K6 F 0402	5k6	~	normal,-1%,1%	0402R
R712	1430690	Bottom	F	5	Chipres 0W06 jumper 0402	OR	~	normal,-,-	0402R
R715	1620033	Bottom	G	3	RES NETWORK 0W06 2X5K6 J 0404	2x5k6	~	normal,-5%,5%	0404_R_SR

Item	Product Code	Location			Description and value				Type
		Side, Grid ref.							
R716	1620033	Bot- tom	G	3	RES NETWORK 0W06 2X5K6 J 0404	2x5k6	~	normal,-5%,5%	0404_R_SR
R717	1620105	Bot- tom	G	2	RES NETWORK 0W06 2X2K2 J 0404	2x2k2	~	normal,-5%,5%	MNR02_SR
R718	1430115	Bot- tom	F	7	Chipres 0W06 2k2 F 200ppm 0402	2k2	~	normal,-1%,1%	0402R
R719	1430700	Bot- tom	F	7	Resistor 5% 63mW	10R	~	normal,-5%,5%	0402R
R720	1430726	Bot- tom	F	5	Resistor 5% 63mW	100R	~	normal,-5%,5%	0402R
R721	1430726	Bot- tom	F	5	Resistor 5% 63mW	100R	~	normal,-5%,5%	0402R
R725	1430730	Bot- tom	F	4	Resistor 5% 63mW	150R	~	normal,-5%,5%	0402R
R726	1430730	Bot- tom	F	4	Resistor 5% 63mW	150R	~	normal,-5%,5%	0402R
R727	1430690	Bot- tom	G	5	Chipres 0W06 jumper 0402	0R	~	normal,-,-	0402R
R730	1430693	Bot- tom	G	3	Chipres 0W06 5R6 J 0402	5R6	~	normal,-5%,5%	0402R
R731	1620507	Bot- tom	H	4	RES NETWORK 0W04 3DB ATT 0404	292R/ 17R6/292R	~	~	0404_RAC10
R732	1430708	Bot- tom	F	4	Resistor 5% 63mW	18R	~	normal,-5%,5%	0402R
R733	1430708	Bot- tom	F	4	Resistor 5% 63mW	18R	~	normal,-5%,5%	0402R
R741	1430728	Bot- tom	F	8	Resistor 5% 63mW	120R	~	normal,-5%,5%	0402R
R742	1430728	Bot- tom	E	8	Resistor 5% 63mW	120R	~	normal,-5%,5%	0402R
R753	1430754	Bot- tom	F	6	Resistor 5% 63mW	1k0	~	normal,-5%,5%	0402R
R801	1430770	Bot- tom	C	7	Resistor 5% 63mW	4k7	~	normal,-5%,5%	0402R
R802	1430754	Bot- tom	C	6	Resistor 5% 63mW	1k0	~	normal,-5%,5%	0402R
R803	1430718	Bot- tom	D	8	Resistor 5% 63mW	47R	~	normal,-5%,5%	0402R
R817	1430754	Bot- tom	G	9	Resistor 5% 63mW	1k0	~	normal,-5%,5%	0402R
R818	1430726	Bot- tom	G	9	Resistor 5% 63mW	100R	~	normal,-5%,5%	0402R
R820	1430754	Bot- tom	G	9	Resistor 5% 63mW	1k0	~	normal,-5%,5%	0402R
R821	1430726	Bot- tom	G	8	Resistor 5% 63mW	100R	~	normal,-5%,5%	0402R
R822	1430762	Bot- tom	G	7	Resistor 5% 63mW	2k2	~	normal,-5%,5%	0402R

Item	Product Code	Location			Description and value				Type
		Side, Grid ref.							
R823	1430700	Bot- tom	G	7	Resistor 5% 63mW	10R	~	normal,-5%,5%	0402R
R824	1430754	Bot- tom	G	6	Resistor 5% 63mW	1k0	~	normal,-5%,5%	0402R
R826	1430726	Bot- tom	G	10	Resistor 5% 63mW	100R	~	normal,-5%,5%	0402R
R827	1430726	Bot- tom	G	10	Resistor 5% 63mW	100R	~	normal,-5%,5%	0402R
R828	1430722	Bot- tom	G	10	Resistor 5% 63mW	68R	~	normal,-5%,5%	0402R
R830	1430690	Bot- tom	F	3	Chipres 0W06 jumper 0402	0R	~	normal,-,-	0402R
R832	1430690	Top	S	6	Chipres 0W06 jumper 0402	0R	~	normal,-,-	0402R
R835	1430690	Bot- tom	N	7	Chipres 0W06 jumper 0402	0R	~	normal,-,-	0402R
S130	5209001	Bot- tom	B	8	SM SW TACT SPST 12V 50MA SIDE KEY	~	~	~	BUTTON_EVQPUA02
T701	4550191	Bot- tom	F	5	TRANSF BALUN 1800+- 100MHZ 2X1.25	~	~	~	TRANS_LDB213
T702	4550187	Bot- tom	H	4	TRANSF BALUN 3600MHZ+-400MHZ	~	~	~	TRANS_LDB213
V101	4120061	Top	D	8	ASIP EMIF02-MIC02F1 2- LINE BGA6	~	~	~	FC6_1.62X1.12
V131	4110089	Bot- tom	N	2	DIX2 BAV70W CC 70V .5A 4NS SOT323	~	~	~	SOT323
V132	4110089	Bot- tom	O	2	DIX2 BAV70W CC 70V .5A 4NS SOT323	~	~	~	SOT323
V136	4110471	Top	Q	9	SCH DI RB520S-30 200MA 30V SOD523	~	~	~	EMD2
V164	4210050	Top	R	9	DIGITAL TR PNP SSM	~	~	~	EM3
V360	4860101	Bot- tom	J	2	IRDA TFDU5102 9.K6- 1M152 BABYFACE	~	~	~	TFDU5102
V361	4202671	Bot- tom	J	3	FET BSS123 N 100V 150MA <6R SOT23	~	~	~	SOT_23_H1.1
V381	4113721	Bot- tom	W	4	TVS DI 1PMT16AT3 16V 175W PWRMITE	~	~	~	CASE_457
V601	4210100	Bot- tom	L	3	Tr NPN 30V 100mA 100MHz SOT323	~	~	~	SOT323
V701	4210197	Bot- tom	E	7	TR NE68119 N 7GHZ LNA NF<1.8 SC75	~	~	~	SC75
V801	4115821	Bot- tom	C	7	SCHDIX2 HSMS282C 15V <1PF SOT323	~	~	~	SOT323_H1.1
V802	4210171	Bot- tom	F	7	TR NE68119 ***RESERVED HDB12***	~	~	~	SC75
X131	5409261	Top	X	6	SM CONN 2X10M P1.5 50V1A PWB/PWB	~	~	~	CPB5520_1301
X133	5469191	Top	C	8	SM CONN 2X9M P0.5 50V 0.5A PCB/PCB	~	~	~	CONN_DF12_18DS_ 0.5V

Item	Product Code	Location			Description and value	Type			
		Side, Grid ref.							
X136	5409263	Bottom	I	6	SM CONN 2X7F P1.4 CAM-ERA VGA	~	~	~	CONN_T_335838_S KT_L14
X470	5409177	Bottom	S	8	SM SIM CARD CONN 2X3POL P2.54	~	~	~	SIM_CARD_3_33806 3
X485	5460045	Bottom	O	9	SM CONN MMC 6POL SPR 30V 0.5A	~	~	~	CON_AMP_C338610
X600	9510434	Bottom	B	5	SPRING CLIP M3E14601 NSJ-3 HD925	~	~	~	ANT_CLIP_M3E1460 1
X601	9510434	Bottom	B	4	SPRING CLIP M3E14601 NSJ-3 HD925	~	~	~	ANT_CLIP_M3E1460 1
X602	5429021	Top	C	2	SM CONN RF+SW 100V 1W 50R 2.2GHZ	~	~	~	COAX_CRS5001
Z130	4120035	Top	D	8	ASIP EMI/ESD10CH IP4041CX25 BGA25	~	~	~	uBGA25_2.64X2.69
Z131	4120031	Top	X	4	EMI/ESD FILT EMIF10-1K010F1 BGA24	~	~	~	uBGA24
Z132	4120031	Top	X	8	EMI/ESD FILT EMIF10-1K010F1 BGA24	~	~	~	uBGA24
Z300	3203741	Bottom	M	3	FERRITE BEAD 0R5 600R/100MHZ 0603	600R/100MHz	~	~	0603_BLM
Z301	3203741	Bottom	M	5	FERRITE BEAD 0R5 600R/100MHZ 0603	600R/100MHz	~	~	0603_BLM
Z302	3203741	Bottom	M	4	FERRITE BEAD 0R5 600R/100MHZ 0603	600R/100MHz	~	~	0603_BLM
Z330	3203741	Bottom	W	7	FERRITE BEAD 0R5 600R/100MHZ 0603	600R/100MHz	~	~	0603_BLM
Z331	3203741	Bottom	W	7	FERRITE BEAD 0R5 600R/100MHZ 0603	600R/100MHz	~	~	0603_BLM
Z332	3203725	Bottom	W	6	FERRITE BEAD 0R6 600R/100M 0402	600R/100MHz	~	~	FERRITE_0402
Z333	3203725	Bottom	W	5	FERRITE BEAD 0R6 600R/100M 0402	600R/100MHz	~	~	FERRITE_0402
Z334	3203729	Bottom	I	8	FERRITE BEAD 0R05 220R/100M 0805	220R/100Mhz	~	normal,-,-	0805_BLM21
Z335	3203729	Bottom	I	9	FERRITE BEAD 0R05 220R/100M 0805	220R/100Mhz	~	normal,-,-	0805_BLM21
Z601	4550255	Bottom	D	7	ANT SW 824-894/1850-1990MHZ 6.7X5	~	~	~	ANT_SW_SHS_L080 K
Z603	4511325	Bottom	D	5	SAW FILT 1960+-30MHZ/4DB 2.5X2.0	1960MHz	~	~	FILTER_SAW_SX_B1 95E
Z604	4511323	Bottom	D	5	SAW FILT 881.5+-25MHZ 3DB 2.5X2.0	881.5MHz	~	~	FILTER_SAW_SAFSD
Z701	4511317	Bottom	F	4	SAW FILT 836.5+-12.5MHZ/2.5DB 2520	836.5MHz	~	~	FILTER_SAW_SAFSD

Component layout diagram Bottom

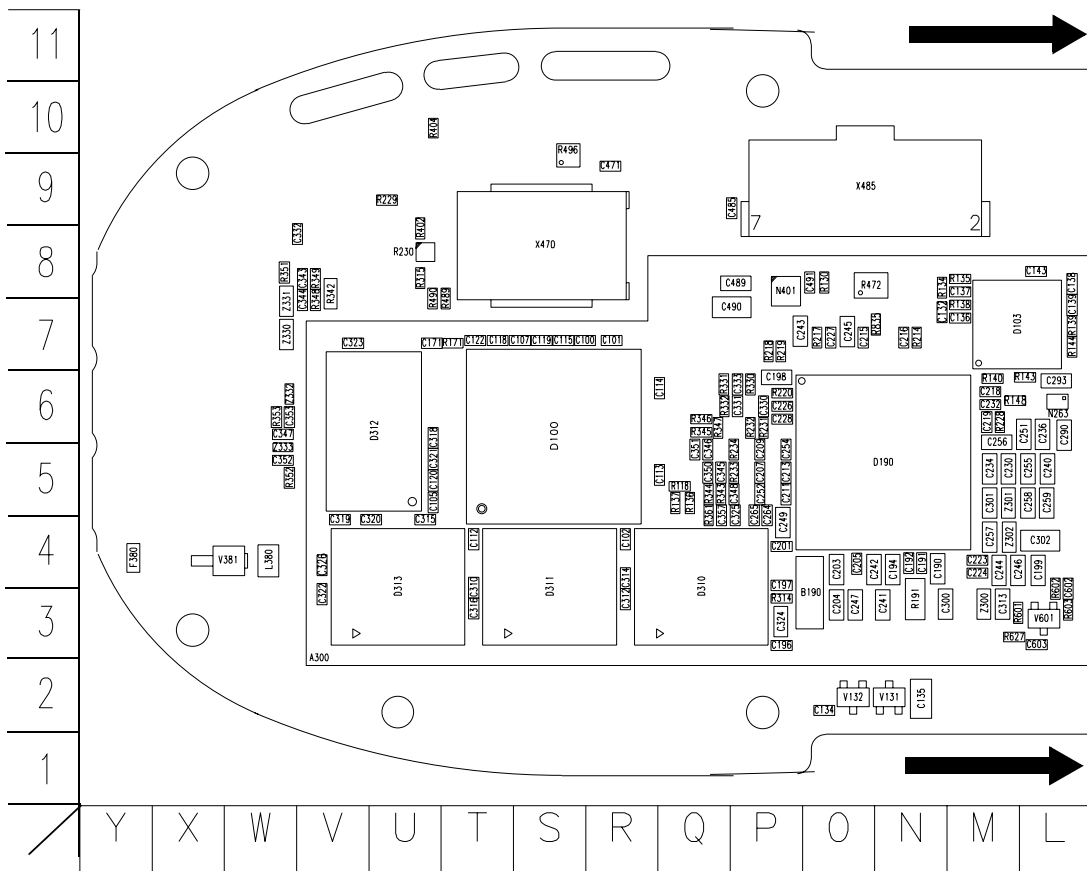
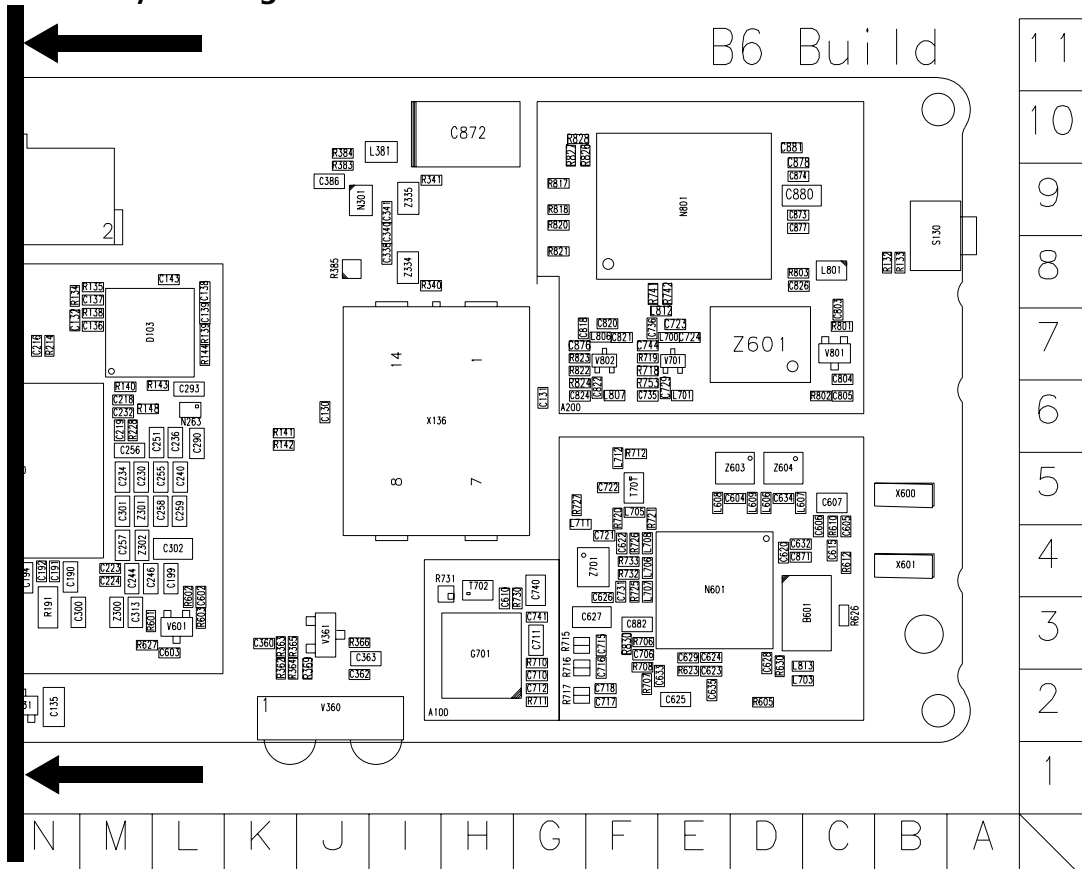

**Component layout diagram Top**

